

Set Up

Inside the Box

- XFINITY Digital Internet and Voice Modem
- Coax cables (20 ft. and 3 ft.)
- Ethernet cable
- Power cord
- Coax cable splitter (optional)
- Cable tacks (optional)
- XFINITY folder

Place Your Equipment



A cordless phone system will be required to use your XFINITY® Voice service on more than one phone throughout your home. Connection of XFINITY Voice service to your home's existing phone jacks requires the assistance of a Comcast technician.

Connect & Power Up

1. Connect a coax cable from your cable wall outlet to the **Cable In/RF In** connection on your modem. You only need one coax cable for this setup, so select the one which best suits your needs.
2. Plug the Ethernet cable into the **Ethernet** connection on your computer, then into the **Ethernet** connection on your modem.
If your connection is different, refer to your XFINITY folder in this kit for alternate connection information.
3. Plug the telephone cord from your telephone into the **Tel 1** connection on your modem.
4. Plug the power cord into your modem, then into an electrical outlet. If your modem has a **Power** button, turn it on.
5. Before proceeding, wait for the online connection light on the front of your modem to stop flashing and remain solid. This light may be labeled *Online, Sync, Cable* or *Ready*. This process may take up to 10 minutes.

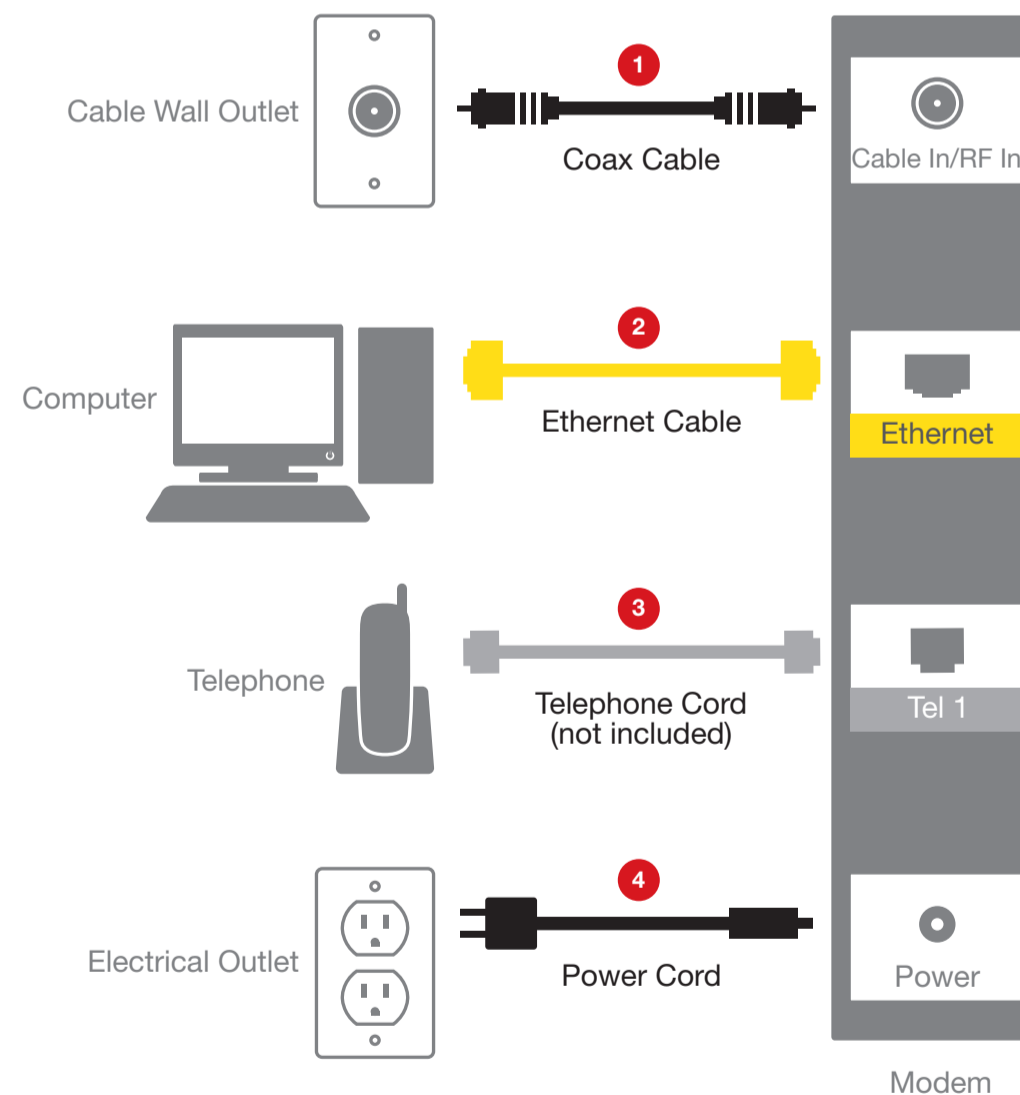

Activate

Before activating your service, ensure all of your kits are set up.

1. Locate your Activation Information card in your XFINITY folder.
2. Go online and you will automatically be connected to the XFINITY Activation Web page.
3. Follow the instructions on the displayed screens.

If you would like to activate your new XFINITY services using your phone, please call **1-855-OK-BEGIN**.

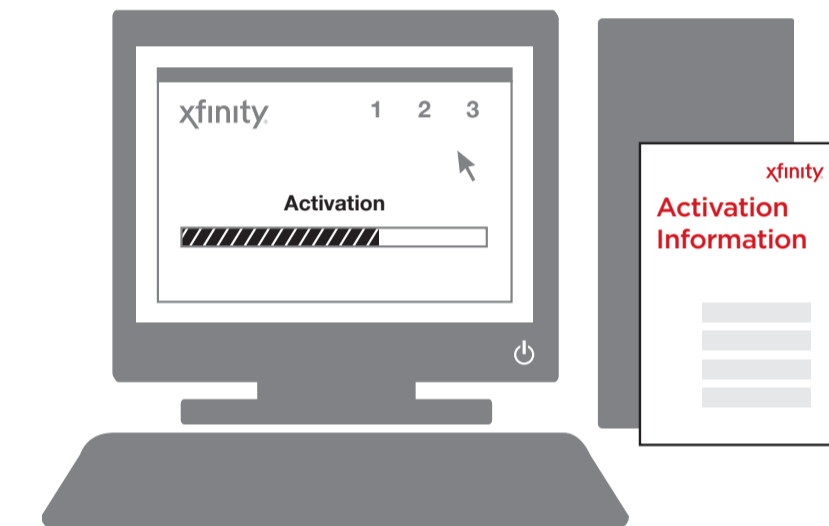

Information on how to set up XFINITY® Internet and Voice features, such as online security and XFINITY voicemail, is available in your XFINITY folder in this kit.

If your device is WiFi capable, you will find a Wireless Gateway Quick Start Guide in this kit that will step you through setting up your home network.

¿Necesita instrucciones en español? Las instrucciones en español están disponibles en su carpeta de XFINITY en este paquete.

Need help? For Troubleshooting Tips, go to www.comcast.com/selfinstall or refer to your XFINITY folder in this kit.